

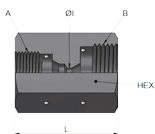

Female MP | Female HP



Part no.	Description	Side A	Side B	ID	HEX	L	MAWP
D9EFA0 4FB040 1	1/4 F-MP F-HP 1/4 20k 316D	1/4	1/4	2.4	3/4 19	36	20k
D9EFA0 4FB060 1	1/4 F-MP F-HP 3/8 20k 316D	1/4	3/8	2.8	1 26	39	20k
D9EFA0 4FB090 1	1/4 F-MP F-HP 9/16 20k 316D	1/4	9/16	2.8	1+3/8 35	44	20k
D9EFA0 6FB040 1	3/8 F-MP F-HP 1/4 20k 316D	3/8	1/4	2.4	3/4 19	39	20k
D9EFA0 6FB060 1	3/8 F-MP F-HP 3/8 20k 316D	3/8	3/8	3.2	1 26	42	20k
D9EFA0 6FB090 1	3/8 F-MP F-HP 9/16 20k 316D	3/8	9/16	4.8	1+3/8 35	47	20k
D9EFA0 9FB040 1	9/16 F-MP F-HP 1/4 20k 316D	9/16	1/4	2.4	1 26	44	20k
D9EFA0 9FB060 1	9/16 F-MP F-HP 3/8 20k 316D	9/16	3/8	3.2	1 26	47	20k
D9EFA0 9FB090 1	9/16 F-MP F-HP 9/16 20k 316D	9/16	9/16	4.8	1+3/8 35	52	20k
D9EFA1 2FB040 1	3/4 F-MP F-HP 1/4 20k 316D	3/4	1/4	2.4	1+3/8 35	50	20k
D9EFA1 2FB060 1	3/4 F-MP F-HP 3/8 20k 316D	3/4	3/8	3.2	1+3/8 35	53	20k
D9EFA1 2FB090 1	3/4 F-MP F-HP 9/16 20k 316D	3/4	9/16	4.8	1+3/8 35	58	20k
D9EFA1 6FB040 1	1 F-MP F-HP 1/4 20k 316D	1.00	1/4	2.4	1+3/4 45	63	20k
D9EFA1 6FB060 1	1 F-MP F-HP 3/8 20k 316D	1.00	3/8	3.2	1+3/4 45	66	20k
D9EFA1 6FB090 1	1 F-MP F-HP 9/16 20k 316D	1.00	9/16	4.8	1+3/4 45	71	20k

