

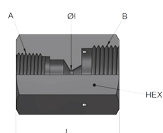

## Female NPT | Female HP



Part no.	Description	Side A	Side B	ID	HEX	L	MAWP
D9DFC 04FB04 01	1/4 F-NPT F-HP 1/4 15k 316D	1/4	1/4	2.4	3/4   19	36	15k
D9DFC 04FB06 01	1/4 F-NPT F-HP 3/8 15k 316D	1/4	3/8	3.2	1   26	39	15k
D9DFC 04FB09 01	1/4 F-NPT F-HP 9/16 15k 316D	1/4	9/16	4.8	1+3/8   35	44	15k
D9DFC 06FB04 01	3/8 F-NPT F-HP 1/4 15k 316D	3/8	1/4	2.4	1   26	39	15k
D9DFC 06FB06 01	3/8 F-NPT F-HP 3/8 15k 316D	3/8	3/8	3.2	1   26	42	15k
D9DFC 06FB09 01	3/8 F-NPT F-HP 9/16 15k 316D	3/8	9/16	4.8	1+3/8   35	47	15k
D9DFC 08FB04 01	1/2 F-NPT F-HP 1/4 15k 316D	1/2	1/4	2.4	1+3/16   30	44	15k
D9DFC 08FB06 01	1/2 F-NPT F-HP 3/8 15k 316D	1/2	3/8	3.2	1+3/16   30	47	15k
D9DFC 08FB09 01	1/2 F-NPT F-HP 9/16 15k 316D	1/2	9/16	4.8	1+3/8   35	52	15k
D9CFC1 2FB040 1	3/4 F-NPT F-HP 1/4 10k 316D	3/4	1/4	2.4	1+3/8   35	44	10k
D9CFC1 2FB060 1	3/4 F-NPT F-HP 3/8 10k 316D	3/4	3/8	3.2	1+3/8   35	47	10k
D9CFC1 2FB090 1	3/4 F-NPT F-HP 9/16 10k 316D	3/4	9/16	4.8	1+3/8   35	52	10k
D9CFC1 6FB040 1	1 F-NPT F-HP 1/4 10k 316D	1.00	1/4	2.4	1+3/4   45	50	10k
D9CFC1 6FB060 1	1 F-NPT F-HP 3/8 10k 316D	1.00	3/8	3.2	1+3/4   45	53	10k
D9CFC1 6FB090 1	1 F-NPT F-HP 9/16 10k 316D	1.00	9/16	4.8	1+3/4   45	58	10k

