



TRANSFER OIL

Pure Fluid Attitude



Female NPT | Torpedo MP

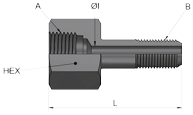

Part no.	Description	Side A	Side B	ID	HEX	L	MAWP
D9DFC 02MS04 01	1/8 F-NPT M-MP* 1/4 15k 316D	1/8	1/4	2.8	5/8 16	43	15k
D9DFC 02MS06 01	1/8 F-NPT M-MP* 3/8 15k 316D	1/8	3/8	5.2	5/8 16	49	15k
D9DFC 02MS09 01	1/8 F-NPT M-MP* 9/16 15k 316D	1/8	9/16	6	3/4 19	55	15k
D9DFC 02MS12 01	1/8 F-NPT M-MP* 3/4 15k 316D	1/8	3/4	6	7/8 22	63	15k
D9DFC 02MS16 01	1/8 F-NPT M-MP* 1 15k 316D	1/8	1.00	6	1+3/16 30	80	15k
D9DFC 04MS0 401	1/4 F-NPT M-MP* 1/4 15k 316D	1/4	1/4	2.8	3/4 19	46	15k
D9DFC 04MS06 01	1/4 F-NPT M-MP* 3/8 15k 316D	1/4	3/8	5.2	3/4 19	52	15k
D9DFC 04MS09 01	1/4 F-NPT M-MP* 9/16 15k 316D	1/4	9/16	8	3/4 19	58	15k
D9DFC 04MS12 01	1/4 F-NPT M-MP* 3/4 15k 316D	1/4	3/4	8	7/8 22	66	15k
D9DFC 04MS16 01	1/4 F-NPT M-MP* 1 15k 316D	1/4	1.00	8	1+3/16 30	82	15k
D9DFC 06MS04 01	3/8 F-NPT M-MP* 1/4 15k 316D	3/8	1/4	2.8	1 26	49	15k
D9DFC 06MS06 01	3/8 F-NPT M-MP* 3/8 15k 316D	3/8	3/8	5.2	1 26	55	15k
D9DFC 06MS09 01	3/8 F-NPT M-MP* 9/16 15k 316D	3/8	9/16	8	1 26	61	15k
D9DFC 06MS12 01	3/8 F-NPT M-MP* 3/4 15k 316D	3/8	3/4	11	1 26	69	15k
D9DFC 06MS16 01	3/8 F-NPT M-MP* 1 15k 316D	3/8	1.00	12	1+3/16 30	85	15k
D9DFC 08MS0 401	1/2 F-NPT M-MP* 1/4 15k 316D	1/2	1/4	2.8	1+3/16 30	54	15k
D9DFC 08MS06 01	1/2 F-NPT M-MP* 3/8 15k 316D	1/2	3/8	5.2	1+3/16 30	60	15k
D9DFC 08MS09 01	1/2 F-NPT M-MP* 9/16 15k 316D	1/2	9/16	8	1+3/16 30	66	15k
D9DFC 08MS12 01	1/2 F-NPT M-MP* 3/4 15k 316D	1/2	3/4	11	1+3/16 30	74	15k
D9DFC 08MS16 01	1/2 F-NPT M-MP* 1 15k 316D	1/2	1.00	14	1+3/16 30	90	15k
D9CFC1 2MS040 1	3/4 F-NPT M-MP* 1/4 10k 316D	3/4	1/4	2.8	1+3/8 35	54	10k
D9CFC1 2MS060 1	3/4 F-NPT M-MP* 3/8 10k 316D	3/4	3/8	5.2	1+3/8 35	60	10k
D9CFC1 2MS090 1	3/4 F-NPT M-MP* 9/16 10k 316D	3/4	9/16	8	1+3/8 35	66	10k
D9CFC1 2MS1201	3/4 F-NPT M-MP* 3/4 10k 316D	3/4	3/4	11	1+3/8 35	74	10k
D9CFC1 2MS1601	3/4 F-NPT M-MP* 1 10k 316D	3/4	1.00	14	1+3/8 35	90	10k
D9CFC1 6MS060 1	1 F-NPT M-MP* 3/8 10k 316D	1.00	3/8	5.2	1+3/4 45	66	10k

D9CFC1 6MS090 1	1 F-NPT M-MP* 9/16 10k 316D	1.00	9/16	8	1+3/4 45	72	10k
D9CFC1 6MS1201	1 F-NPT M-MP* 3/4 10k 316D	1.00	3/4	11	1+3/4 45	80	10k
D9CFC1 6MS1601	1 F-NPT M-MP* 1 10k 316D	1.00	1.00	14	1+3/4 45	96	10k

*I valori e le dimensioni mostrate possono essere modificati senza preavviso per migliorare le prestazioni e l'affidabilità del prodotto.
Transfer Oil S.p.A. non si assume alcuna responsabilità per imprecisioni o errori che appaiono in questa scheda tecnica.*

Data documento: 13/04/2026

www.transferoil.com